

**A1GP World Cup of Motorsport Race Meeting**  
**May 2<sup>nd</sup>, 3<sup>rd</sup> & 4<sup>th</sup>**  
**Brands Hatch**  
**FINAL INSTRUCTIONS**

**Issue ONE**

**This meeting is organised by MotorSport Vision Racing, governed by the General Competition Rules of the MSA, incorporating the provisions of the International Sporting Code of the FIA, additional Supplementary Regulations and any written instructions the organisers issue for the event.**

**1. PERMIT**

This event will be held under the following MSA Permit numbers: Int: 45105 Nat B: 45104  
This event is NEAFP permitted.

**2. OFFICIALS**

MSA Steward – Mr D Pierre (Int)  
MSA Stewards – Mr J Oliver (National)  
Club Stewards – Mr B Shewan, Mr A Steele  
Event Director and Senior Clerk of the Course - David Scott  
Clerks of the Course – Brian Poulter, Nick Turner, Julian Floyd (Britcar), Barry Ashman (Sports 2000), Bernard Cottrell (Formula Ford)  
Deputy Clerk of the Course – Barry Morris, Mike Norman  
Assistant Clerk of the Course – Anita Williams  
Secretary of the Meeting – David Willey  
Deputy Secretary of Meeting – Penny Mount  
Chief Scrutineer - Chris Mount  
Chief Medical Officer – Dr Alan Pearce  
Starter – Rod Marshment  
Chief Paddock Marshal – Vincent Markey  
Chief Timekeeper – John Ward  
Race Control Secretary - Gill Barnett  
Commentators – David Addison and Bob Constanduros  
Press Officer – Chelsea Reay  
Marshals/Event Officials - Members of the BMMC, BARC & BRSCC and other MSA recognised Clubs  
Ambulances – St John Ambulance  
Medical Services – St John Ambulance  
Rescue Units – MSVR, BRSCC SE  
Rescue Unit Chief – Andy Lyle  
Recovery – D&G Cars

**3. COMPETITORS CIRCUIT/PADDOCK ACCESS & ALLOCATION**

IT IS IMPORTANT THAT YOU FOLLOW INSTRUCTIONS REGARDING PARKING WITHIN THE PADDOCK AREAS.

Paddock access will be from **Thursday 1<sup>st</sup> May from 08:00** for all competitors.

**Use of Pit Garages**

No access for support race competitors.

#### **4. SIGNING ON FOR COMPETITORS**

Signing on for all competitors will be as **indicated on the timetable**.

At signing on all drivers must provide a) Drivers and Entrants MSA Competition Licence. b) Drivers Medical Certificate (if not incorporated in the Licence). c) Valid Club Membership (where applicable).

Drivers are reminded that licences and medicals must be valid, bearing a recent photograph and be signed **before** presentation to the officials at Signing On. Without these they are not valid.

#### **5. SIGNING ON FOR SENIOR OFFICIALS**

Will be in Race Administration.

#### **6. NOTICE BOARD**

The Official Notice Board will be located at Race Administration.

#### **7. TIMING SCREEN**

The Official Timing Screen will be the Starters timing screen in the Pit Lane.

#### **8. SCRUTINEERING**

All vehicles will be examined in situ in the Paddock **at the times given on the timetable**.

It is essential that cars and drivers equipment is available at the prescribed times. Any cars & drivers equipment not ready for inspection at the prescribed time may be delayed and may be required to attend the scrutineering bay.

#### **9. ELIGIBILITY**

Eligibility may be checked by a member of the MSA Technical Commission listed: C Barnett, R E Bassett, M E Garton, J M Harris, K W Laidlaw, P Liddle, R J McDonald, C A Mount, A J Parsfield, P C Riches, D Russell, & S Vincent. These Technical Commissioners will be considered as Judges of Fact within the Regulations.

The Championship MSA Licensed Eligibility Scrutineers are also considered Judges of Fact and empowered to undertake any measurements or examinations of vehicles.

#### **10. DRIVERS RACING FOR THE FIRST TIME AT BRANDS HATCH**

Competitors must read an instruction sheet that can be collected from Race Administration prior to their qualifying sessions.

#### **11. DRIVERS BRIEFINGS**

Drivers' briefings will be in accordance with the timetable.

The organisers reserve the right to call extra briefings as appropriate.

Attendance at any drivers briefing is mandatory.

#### **12. ENGINE / NOISE POLLUTION**

Engines must not be run before 0830 hours OR after 1830 hours on 2 & 3 May.

Engines must not be run before 0930 hours OR after 1830 hours on 4 May.

#### **13. PIT LANE**

Please note that there is a mandatory speed limit in the Pit Lane of 60 km/h.

The Penalty Box is in the Pit Lane adjacent to Race Control.

#### **14. QUALIFYING**

Qualifying will start from the pit lane.

All cars will proceed from the assembly area to the Pit Lane behind a control car. Please see **Paddock Procedure ONE** for information.

#### **15. RACE START PROCEDURE**

All cars will proceed from the assembly area to the grid behind a control car. Please see **Paddock Procedure ONE** for information.

All starts will be in accordance with their Championship Regulations.

Any race taking more than three minutes to complete the formation lap may have its race reduced in time.

#### **16. GRIDS**

Starting Grids will be in accordance with the track licence.

#### **17. COUNTDOWNS**

For all support races, the countdown will start at the 1 minute signal.

#### **18. SAFETY CAR**

The Clerk of the Course has the option to deploy a Safety Car for all **qualifying and races**.

The Safety Car will join the circuit at Marshals Post 8 and leave the circuit by entering the Pit Lane. Safety Car regulations are available at Race Administration.

#### **19. LIVE SNATCH**

Brands Hatch is licenced for Live Snatch. During racing or qualifying any car that needs removing from a gravel trap may be removed by a 'snatch vehicle' under local yellow flags.

#### **20. END OF QUALIFYING PROCEDURE**

All competitors will go immediately to Parc Fermé in the outer paddock scrutineering bay or at their paddock location as directed by officials.

Please see **Paddock Procedure TWO** document.

#### **20. END OF RACE PROCEDURE**

Cars required for the podium will proceed directly to the podium and be placed under Parc Fermé conditions.

All remaining competitors will go immediately to Parc Fermé in the outer paddock scrutineering bay or at their paddock location as directed by officials.

Please see **Paddock Procedure TWO** document.

Cars will be held under Parc Fermé conditions until released by the Chief Scrutineer.

Where support races are of a set time duration, the Chequered Flag will be shown to the race leader the first time he passes the finish line after the time has elapsed unless specified.

## 21. RESULTS

Results of Qualifying and Races will remain provisional until MSVR declare them as Final. The declaration of results will be published on the notice board throughout the meeting and, at the latest, at the end of the meeting (subject to any outstanding judicial matters).

## 22. JUDGES OF FACT

The Judges of Fact will be the Judges, Timekeepers, Observers, Flag Marshals, Scrutineers & Technical Commissioners.

**Starting Judges:** To declare any false starts or other infringements.

**Finishing Judges:** To declare the order in which the cars cross the finish line when the end of the race is given or the scheduled race distance is completed by the winner.

**Timekeepers:** To declare the individual lap times and the order in which the cars cross the timing line throughout the competition.

**Flag Marshals:** To declare any infringements of the signals prescribed in Appendix H of the International Sporting Code.

**Scrutineers & Technical Commission:** To declare any infringement of Vehicle safety and eligibility.

## 23. TIMING

All competitors are required to use an AMB TranX 260 either direct powered or battery transponder. Transponders will NOT be available during the meeting and cars without a transponder will not be timed.

Competitors are required to supply the transponder number in advance of the event to their respective Championship Coordinator.

## 24. SPECIAL CIRCUIT NOTICES

- i) MSV & MSVR shall not be liable in the event of damage caused to vehicles being recovered from the track.
- ii) No photographic recording or similar equipment of any description shall be allowed onto the Venue without MSV's written consent.
- iii) Pit lane: Children under the age 16 years old are not admitted to the pits area.
- iv) No smoking is permitted in the Pit Lane.
- v) The use of fun bikes is not permitted unless towing a trailer for the purpose of transporting ancillary motor race equipment. No competitor may ride motorcycles or cycles in the pit road at any time when the circuit is operational. Any misuse of "paddock bikes" will be brought to the attention of the Senior Officials and appropriate action will be taken.

We wish you a safe and successful meeting.

**Dave Scott**  
Event Director

**David Willey**  
Secretary of the Meeting

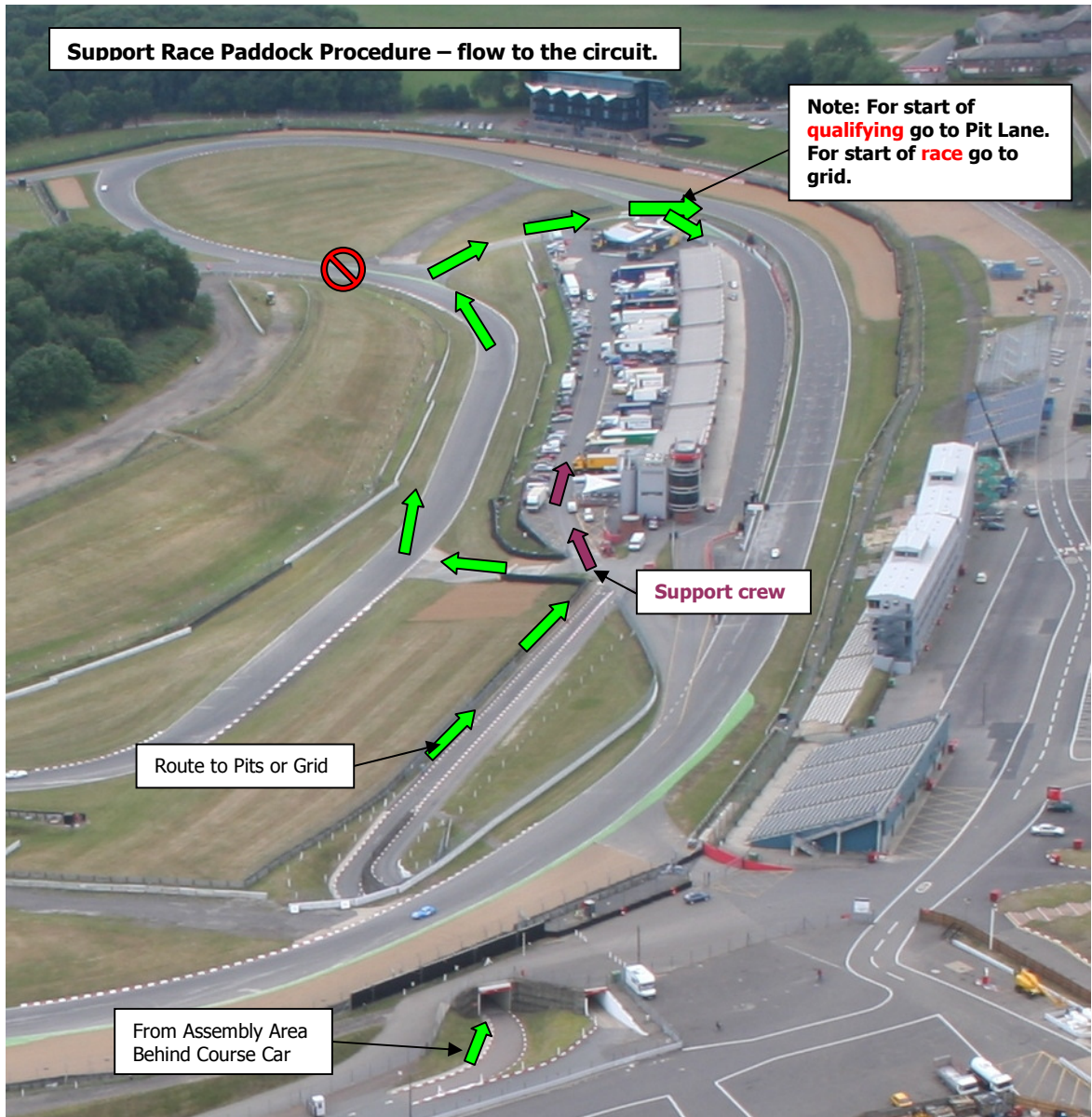

**Paddock Procedures ONE**

**MotorSport Vision  
Racing**  
MotorSport Vision Centre  
Brands Hatch , Fawkham  
Longfield, Kent DA3 8NG

Tel +44 (0) 1474 872 331  
Fax +44 (0) 1474 874 766  
Email [info@msvracing.co.uk](mailto:info@msvracing.co.uk)  
Website [www.msvracing.co.uk](http://www.msvracing.co.uk)

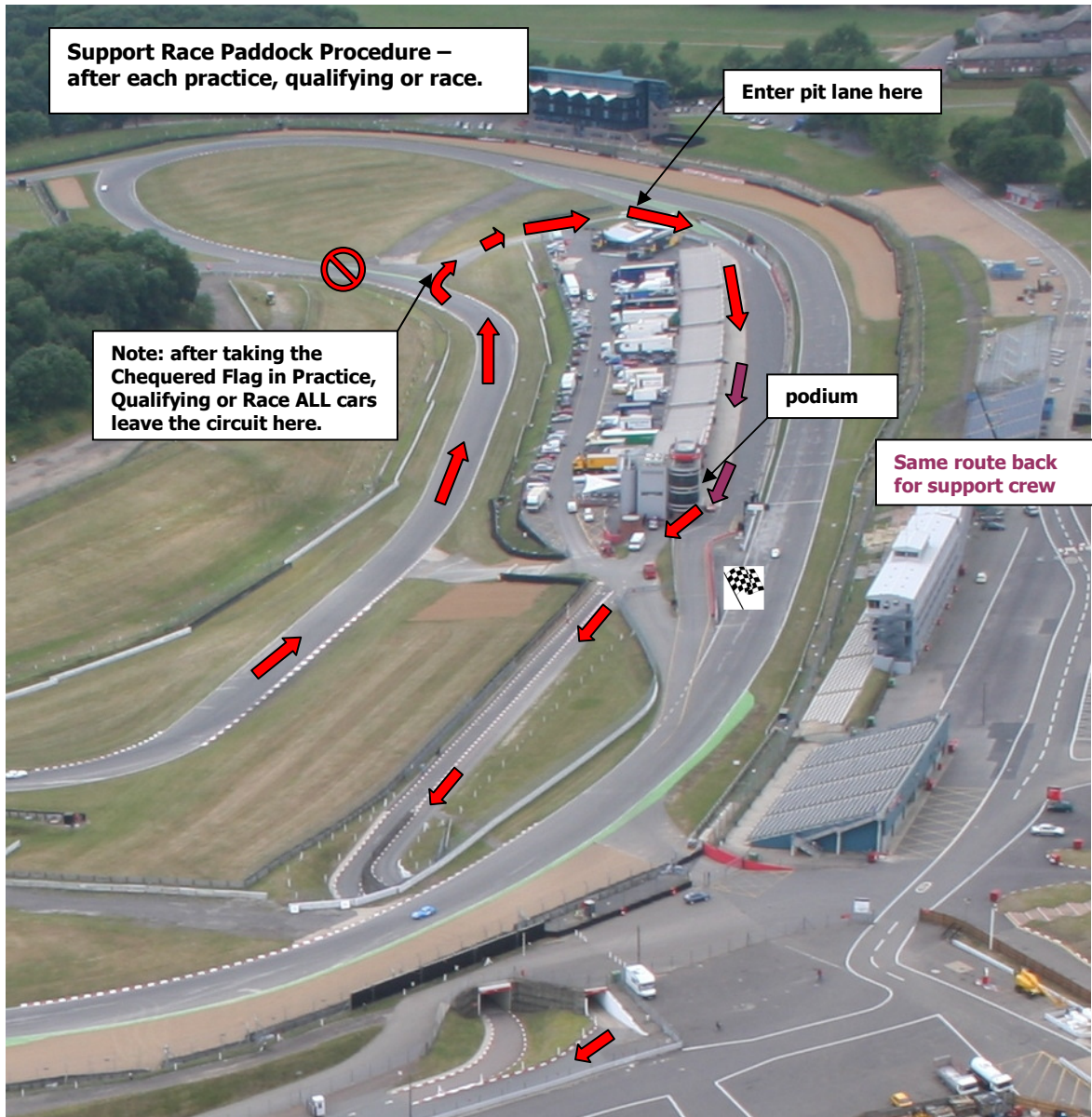

**Paddock Procedures TWO**

**MotorSport Vision Racing**  
MotorSport Vision Centre  
Brands Hatch , Fawkham  
Longfield, Kent DA3 8NG

Tel +44 (0) 1474 872 331  
Fax +44 (0) 1474 874 766  
Email [info@msvracing.co.uk](mailto:info@msvracing.co.uk)  
Website [www.msvracing.co.uk](http://www.msvracing.co.uk)